

LAP JOINT FLANGE

ASTM A182 • ASME B16.5

FFLJ

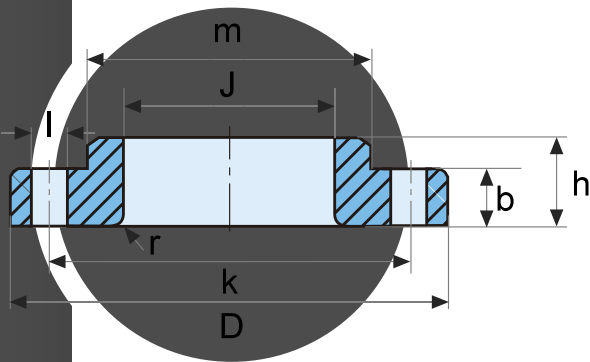

Material Spec.

ASTM A182 • A182M-17

ASME SA182 • SA182M-15

FLAT FACE, SMOOTH FINISH (125–250 RMS/3.2–6.3 μm) 150 lbs

Order example:

● = FFLJ-316L-2-150

| Pipe | Flange | | | | | | Hub | Drilling Template | | | Weight | Stock |
|-----------|---------|-------|-------|------|------|------|-------|-------------------|-------|--------------|--------|-------|
| Nom. Size | O.D. mm | D mm | J mm | b mm | h mm | r mm | m mm | I mm | k mm | No. of Holes | kg/pce | 316L |
| 1/2" | 21.3 | 88.9 | 22.9 | 11.2 | 15.7 | 3.0 | 30.2 | 15.7 | 60.5 | 4 | 0.390 | ● |
| 3/4" | 26.7 | 98.6 | 28.2 | 12.7 | 15.7 | 3.0 | 38.1 | 15.7 | 69.9 | 4 | 0.560 | ● |
| 1" | 33.4 | 108.0 | 35.1 | 14.2 | 17.5 | 3.0 | 49.3 | 15.7 | 79.2 | 4 | 0.780 | ● |
| 1 1/2" | 48.3 | 127.0 | 50.0 | 17.5 | 22.4 | 6.4 | 65.0 | 15.7 | 98.6 | 4 | 1.320 | ● |
| 2" | 60.3 | 152.4 | 62.5 | 19.1 | 25.4 | 7.9 | 77.7 | 19.1 | 120.7 | 4 | 2.060 | ● |
| 3" | 88.9 | 190.5 | 91.4 | 23.9 | 30.2 | 9.7 | 108.0 | 19.1 | 152.4 | 4 | 3.850 | ● |
| 4" | 114.3 | 228.6 | 116.8 | 23.9 | 33.3 | 11.2 | 134.9 | 19.1 | 190.5 | 8 | 5.300 | ● |
| 6" | 168.3 | 279.4 | 171.5 | 25.4 | 39.6 | 12.7 | 192.0 | 22.4 | 241.3 | 8 | 7.450 | ● |